

**Boiler House Piping (BHP) Engineering**  
**Client: ISGEC Heavy Engineering, Chennai**  
**Project: Ramco Cements**

**Scope Of Work:** Stress analysis of Boiler MSSV outlet piping of two Cement Plant Waste Heat Boilers, 6 TPH behind Pre Heater (PH) and 34.4 TPH behind Air Quenching Cooler (AQC), Turbine exhaust, Turbine Bypass piping and Auxiliary steam header and its Desuperheating system

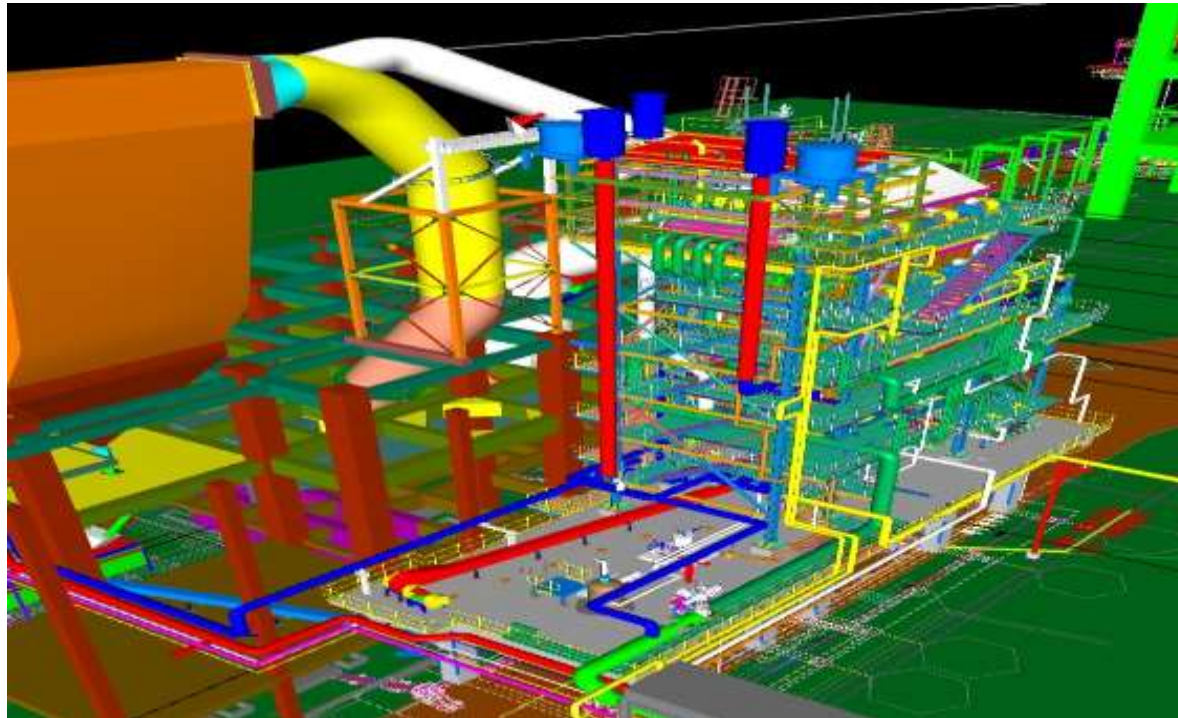

**Boiler House Piping (BHP) Engineering**  
**Client: ISGEC Heavy Engineering, Chennai**  
**Project: Ramco Cements**

